

Kum & Go Excess Retail

SW/C W. Lakeview Road & N. Perkins Road
Stillwater, OK

918-481-8888

www.walmancommercial.com



STORE UNDER CONSTRUCTION - OPENING SPRING 2008

- **1,727 SF Available**
- **Shared pole and monument signage available.**
- **Shared interior access with Kum & Go.**
- **Separate parking field adjacent to building.**
- **Hard corner location on Perkins Road, a main exit off Hwy 412.**
- **Oklahoma State University has a student population of over 24,000.**

Co-brand with the nations 19th largest convenience store operator!

DEMOGRAPHICS

MILE RADIUS	1	3	5
Population:	3,255	29,259	43,073
Households:	1,402	10,825	16,155
Avg. H.H. Income:	\$54,349	\$37,760	\$42,020

Traffic Counts: N. Perkins Road - 20,100 cpd



6846 S. Canton
Suite 540
Tulsa, OK 74136
Tel: 918.481.8888
Fax: 918.481.8866

All statements herein are for informational purposes only and are believed to be reliable; however, no warranty or representation is made to the accuracy thereof and the same is submitted subject to errors, omissions, change of price, terms, conditions and prior sale or lease.

Kum & Go Excess Retail

SW/C Lakeview Road & N. Perkins Road
Stillwater, OK

West Lakeview Road

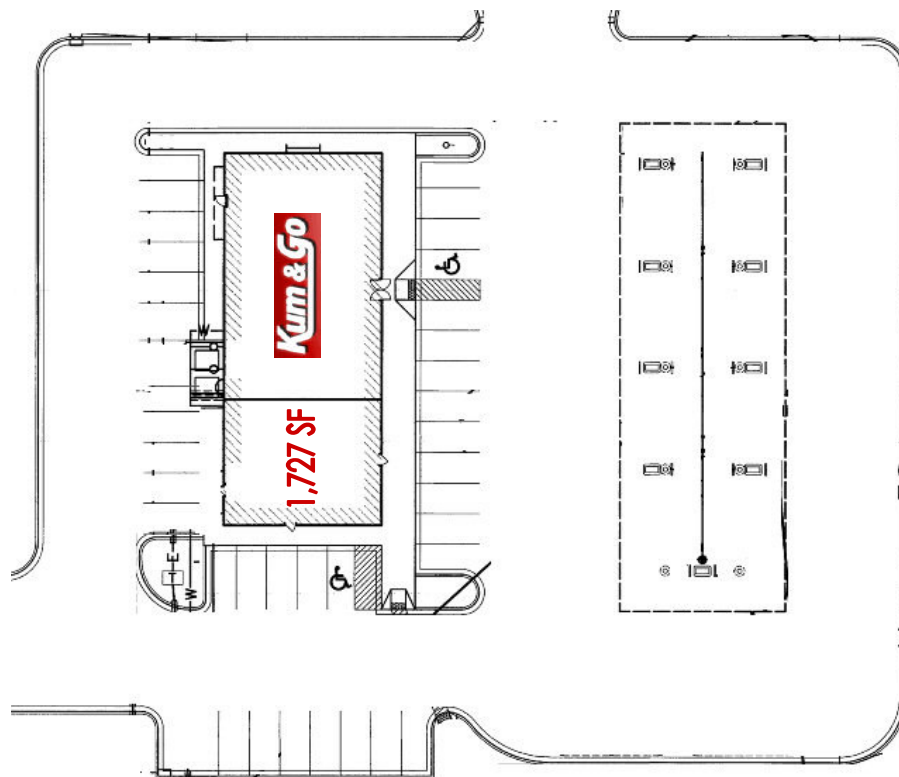

N. Perkins Road

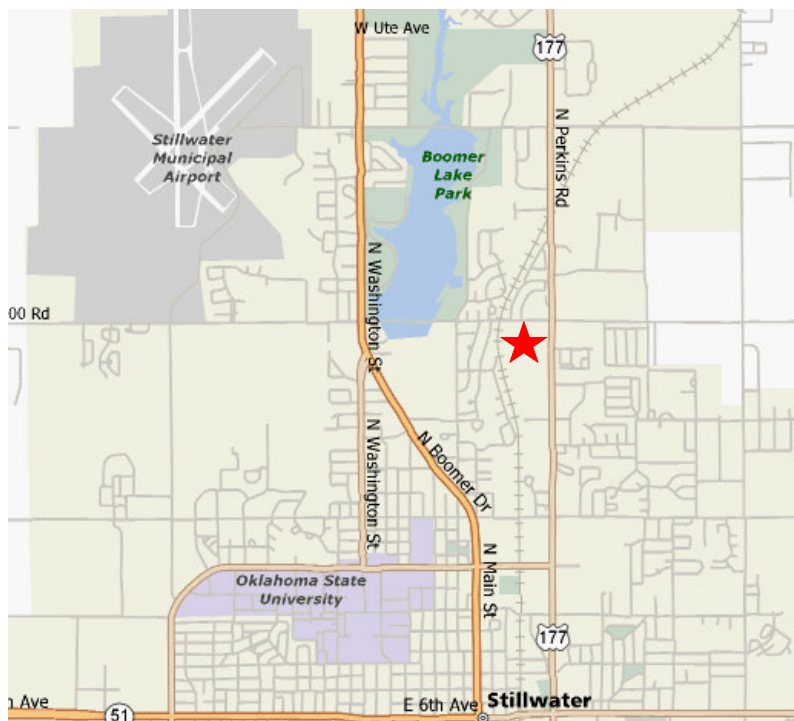

*Co-brand with the nations 19th
largest convenience store operator!*



6846 S. Canton, Suite 540 Tulsa, OK 74136
Tel: 918.481.8888 Fax: 918.481.8866

All statements herein are for informational purposes only and are believed to be reliable; however, no warranty or representation is made to the accuracy thereof and the same is submitted subject to errors, omissions, change of price, terms, conditions and prior sale or lease.