

Retail Land
3865 121st Street
Urbandale, Iowa

FOR SALE

For more information, contact:

Todd Millang, CCIM
Senior Vice President
515.221.6677
todd.millang@cbre.com

Philip Kreis, CCIM
Sales Associate
515.221.6672
philip.kreis@cbre.com



As Exclusive Agent for the owner, we are pleased to offer the following property:

- ▶ PREMISES:
 - Approximately 1.15 acres
 - Adjacent to future Kum & Go
 - Close to Interstate 35

- ▶ SALE PRICE: **\$13.00 per square foot**

CB Richard Ellis/Hubbell Commercial
6900 Westown Parkway
West Des Moines, IA 50266

main: 515.224.4900
fax: 515.221.6652

LISTING #754568

www.cbrehc.com

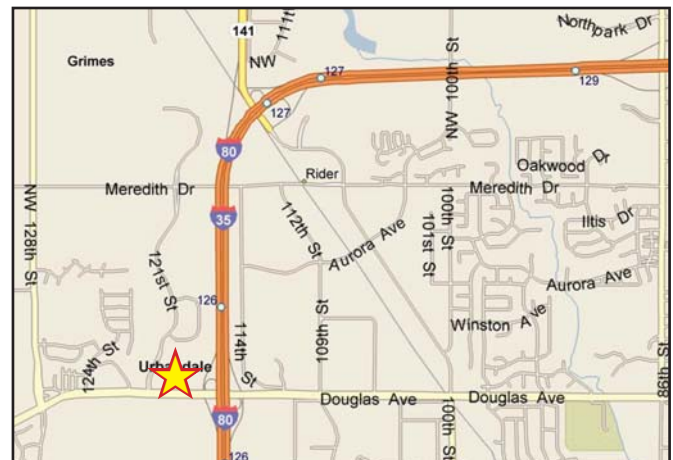

© 2008 CB Richard Ellis, Inc. We obtained the information above from sources we believe to be reliable. However, we have not verified its accuracy and make no guarantee, warranty or representation about it. It is submitted subject to the possibility of errors, omissions, change of price, rental or other conditions, prior sale, lease or financing, or withdrawal without notice. We include projections, opinions, assumptions or estimates for example only, and they may not represent current or future performance of the property. You and your tax and legal advisors should conduct your own investigation of the property and transaction.

CBRE | Hubbell
CB RICHARD ELLIS | COMMERCIAL